

Typical temporary support for new beam below existing masonry wall

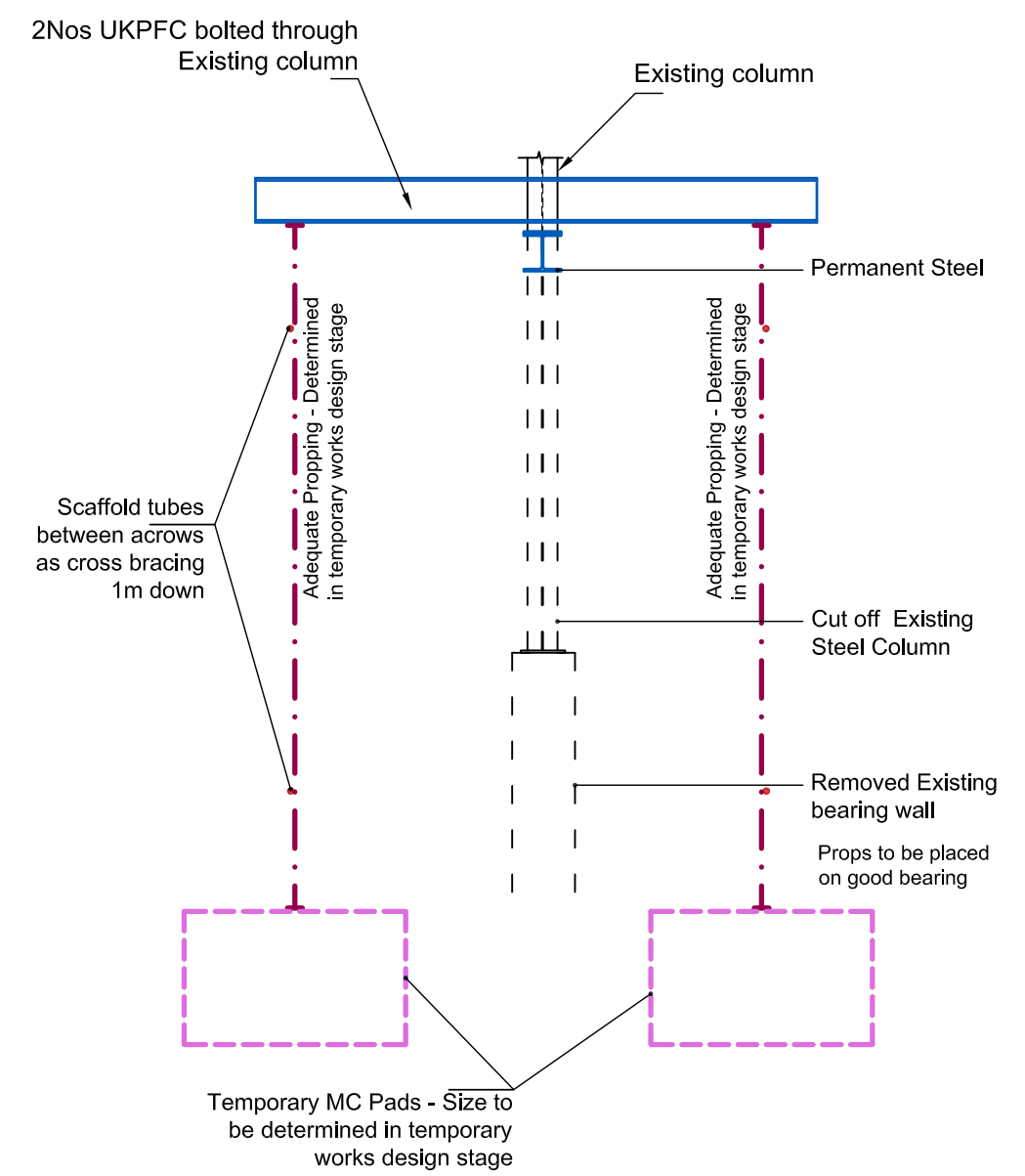

Typical temporary support for removal of the column and re-support with new beam

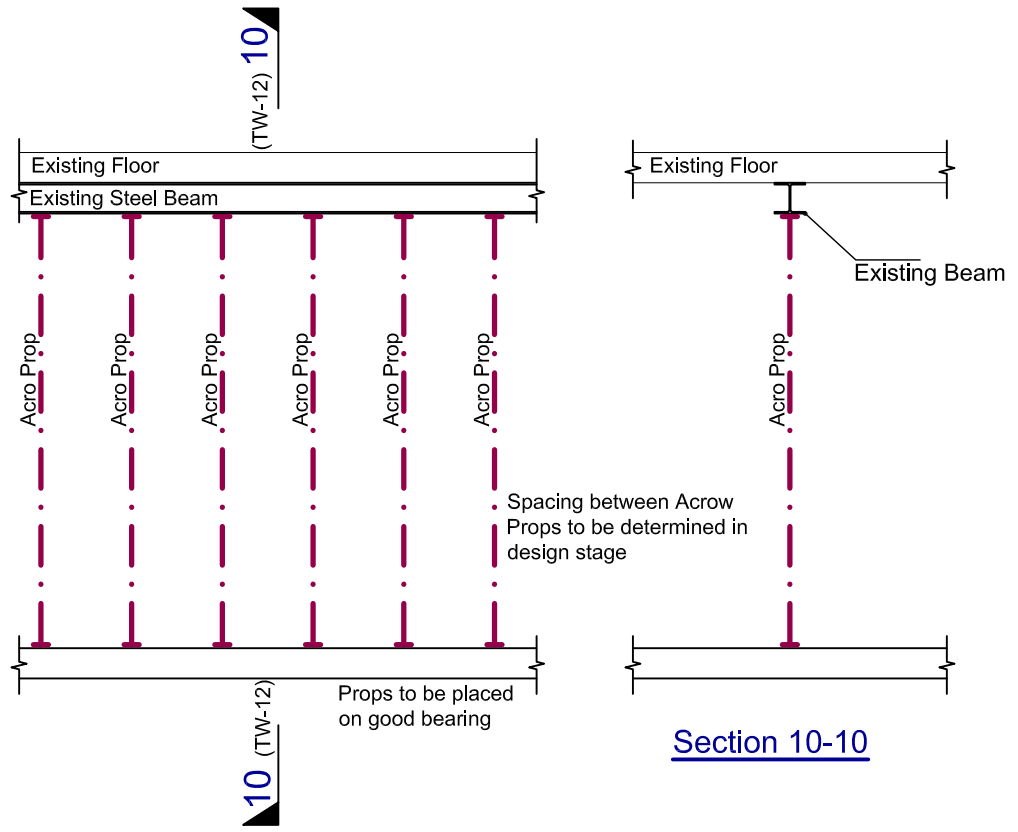

Typical temporary support for existing, retained steel beams supporting the floor

For Planning Purposes Only		
Rev	Date	Amendments
-	30/07/2019	First issue for comment

Job Number 190723	Date July '19
Dwg Number TW-12	Rev -
Drawn pr	Chkd CT
Scale As shown @ A3	

Client: Mr Barat Palmer
Project: Suna Restaurant
Title : Typical temporary works details

Croft Structural Engineers

Clockshop Mews,
r/o 60 Saxon Rd,
London, SE25 5EH.
020 8684 4744
www.croftse.co.uk